

INSTALLATION INSTRUCTIONS

COLONY® BATH WALL SET

MODEL: 2978BWT

*American
Standard*

Visit www.americanstandard.com for coordinating products.

Thank you for selecting American Standard – the benchmark of fine quality for over 100 years. To ensure this product is installed properly, please read these instructions carefully before you begin. (Certain installations may require professional help.) Also be sure your installation conforms to local codes.

BEFORE YOU BEGIN....

Local building codes vary by location. Observe all local plumbing and building codes.

Unpack your new shower walls and inspect them carefully for damage. Verify that the walls are the correct size for your installation. Refer to American Standard roughing-in information for specific dimensions for each model.

NOTE: Remove protective plastic coating material from surface of panel before installation.

NOTE: Take extra care in handling the front surfaces of the walls. Use only non-abrasive cloths to avoid scratching.

REQUIRED TOOLS AND MATERIALS

TOOLS:

Pencil	Tape Measure
Drill	Caulking Gun
Hole Saw or	Level
Sabre Saw	Square

MATERIALS:

Acrylic/Latex or Acrylic/Silicone Sealant
Mineral Spirits

PREPARATION: Must be installed over **SHEETROCK/GREENBOARD** or **CEMENT/CONCRETE**.

Illustration 1

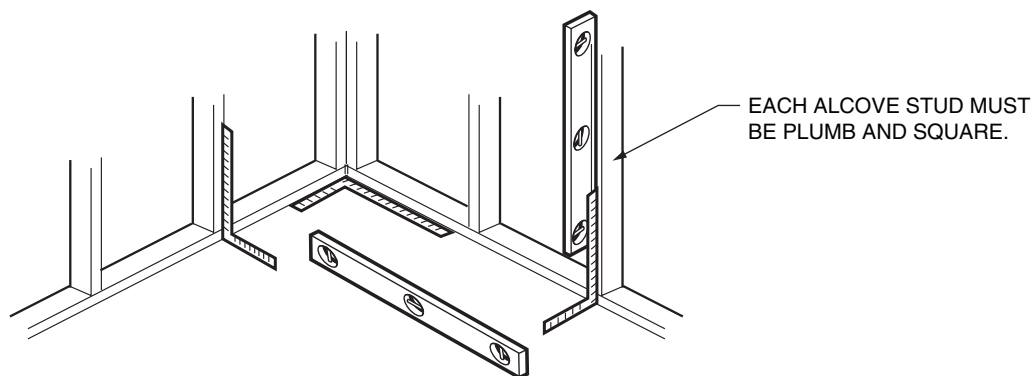

A) WALL SURFACE PREPARATION

Ensure wall surface is dry, smooth, and free of dust, soap scum, mold or other contaminants. Wipe wall surfaces with a damp cloth and allow to dry.

Wall surface must be dry before panels can be applied.

Ensure that alcove is plumb and square. (Illustration 1)

INSTALLATION over OLD TILE

Rough up glossy tile surfaces using belt sander with 60-grit sandpaper.

Surface must be dry, smooth and free of any dust or any other contaminants.

Wipe wall surfaces with a damp cloth and allow to dry.

B) ROUGH PLUMBING & FITTINGS MUST BE INSTALLED BEFORE WALLS

Turn off hot & cold water supplies.

Remove faucet handles, escutcheons, filler spouts and any other fixtures & fittings (e.g. towel bars, soap dishes, etc.).

Use hammer & chisel to remove objects cemented to walls.

Old ceramic tiles, if solidly adhered to walls, need not be removed.

Loose ceramic tiles must be removed and sub walls sanded smooth.

C) IF YOU PLAN TO INSTALL A SHOWER DOOR

Follow manufacturer's instructions and prepare stud wall accordingly.

1

DRY FITTING THE PANELS ON THE WALL

- 1) Dry fit the panels starting with the rear panel first keeping it centered, equal distance between the 2 rear corners of the wall. Mark a vertical line top to bottom at the corner edges of the panel on the rear wall to ensure panel is centered between the 2 corners as a reference.
See **Illustration 2**

- 2) When dry fitting for side panels, place the panels entrance edge at the desired location on wall while also ensuring a gap or distance no greater than 7-3/4" (197mm) exists at the panels back corner to the rear wall. Mark a vertical line top to bottom on the side wall near the corner at back edge of side panel to reference later. Repeat for opposite side panel wall.

NOTE: Verify that the gaps at both rear corners can be covered by the "Corner Panels" by dry fitting or placing a corner panel in each corner while observing the corner panel covers or overlaps both rear and side panels by at least 1/4" (6mm).

- 3) Once side panels are properly dry fitted, mark all plumbing locations where shower valves or shower heads come through the side panel. Drill holes at each location using hole saws large enough to accommodate the opening but small enough to be covered by the trim plates.
See **Illustration 3**

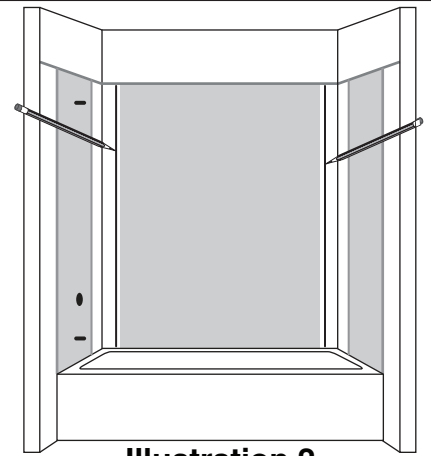

Illustration 2

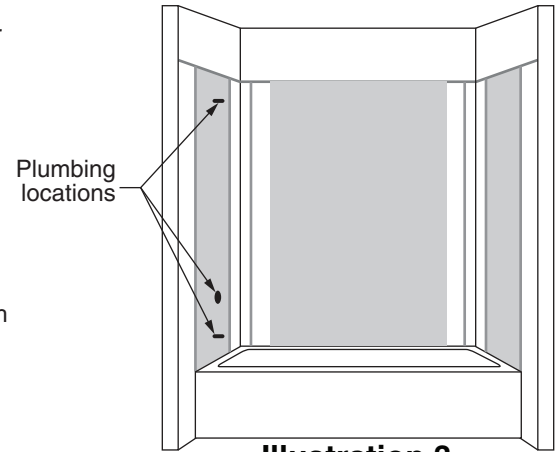

Illustration 3

2

APPLYING ADHESIVE TO DRYWALL AND SEALANT TO TUB BASE

NOTE – INSTALL ONLY ONE WALL AT A TIME.

- 1) Wipe all back side of panels and walls with a damp cloth to remove any dust or debris and allow to fully dry.
- 2) Apply adhesive in a zig-zag pattern on the wall, keeping bead thickness to 1/8" (3mm) or less.
See **Illustration 4**

NOTE: Applying beads of adhesive thicker than 1/8" (3mm) may make it difficult to spread behind the panel once it is up and installed creating a ripple effect on the panel.

- 3) Move rear panel onto the wall keeping a space of approximately 1/8" (3mm) off of the surface of the tub deck and keeping panel between the marked lines previously drawn. Press panel firmly over entire surface to ensure firm contact of panel to adhesive on wall.
See **Illustration 5**

NOTE: It may be necessary to brace or support the panel against the wall until the panel stays securely in place. Place a cloth under the supports to prevent marring of the walls surface.

- 4) Install side panels in the same manor using the same adhesive pattern. Wipe off any excessive adhesive with mineral spirits.

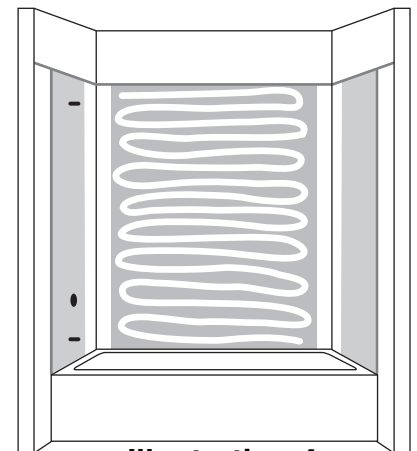

Illustration 4

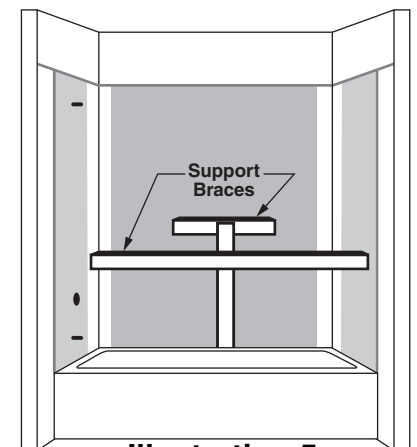

Illustration 5

INSTALLING THE CORNER PANELS

- 1) Place corner panel into rear corner of shower and check for proper fit of corner panel to shower walls. Ensure corner panels completely overlap both rear and side panels by at least 1/4" (6mm).
- 2) Apply adhesive to one rear corner at a time (as illustrated) top to bottom, side to side and on back of the corner panel and place into rear corner of shower. Press firmly to hold in place.
See **Illustration 6**

NOTE: It may be necessary to brace or support the corner panel in position until the adhesive dries. Use cloth under any support to prevent any marring of the walls finished surface.

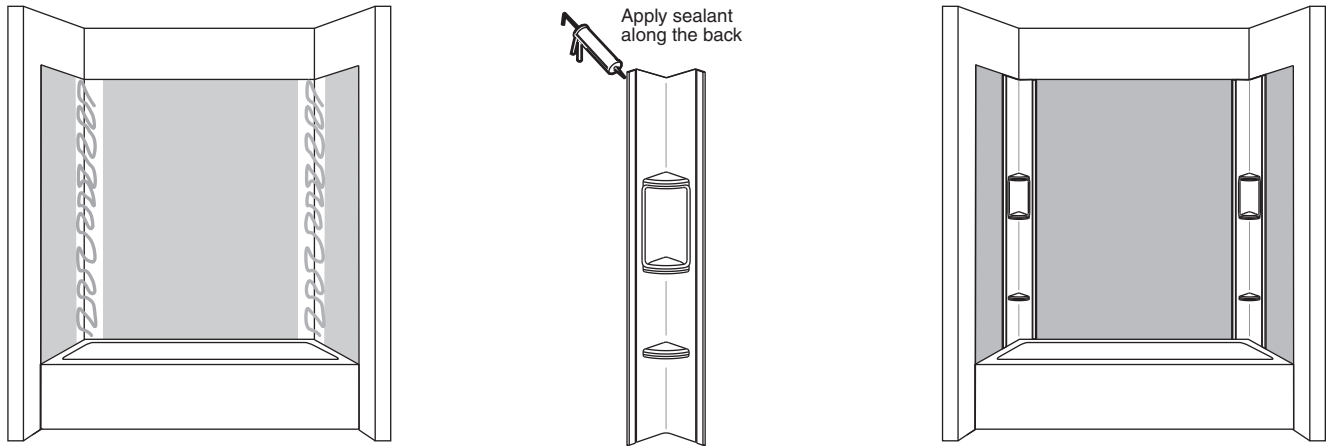

Illustration 6

- 3) Wipe the panel down with a damp rag while continuing to apply pressure to the panel to ensure it makes complete contact.

NOTE – WIPE ANY EXCESS ADHESIVE FROM THE PANEL WITH A DAMP RAG OR MINERAL SPIRITS

APPLYING SEALANT AND INSTALLING SHOWER HANDLE AND SHOWER HEAD

- 1) Allow 24 hours for the wall panel adhesive to dry before applying the sealant as shown.
- 2) Apply a bead of sealant around all corners, outside edges of panels, corner panels and deck of tub.
See **Illustration 7**
- 3) Install the shower handle and shower head per the manufacturer's instructions. Be sure to apply sealant to all trim plates.

Note – allow 24 hours for the sealant to dry before use.

Install the shower door or shower curtain rod according to the manufacturer's instructions.

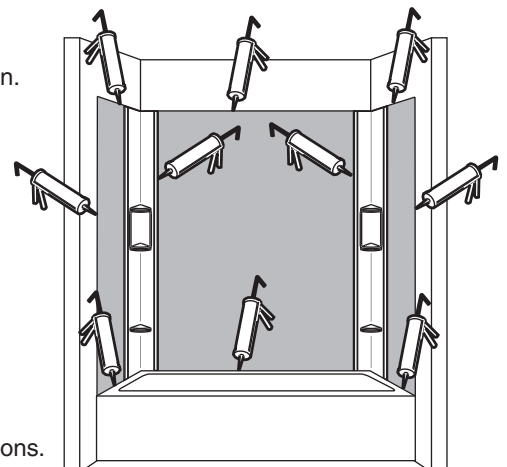

Illustration 7

POST INSTALLATION CLEAN-UP

Remove all construction debris. Tile grout can be removed with a wooden popsicle stick or tongue depressor. Do not use wire brushes or any other metal implement on surface.

Post installation clean-up generally can be completed using warm water and liquid dishwashing detergent. Stubborn dirt or stains may be removed using granular Spic and Span® mixed with water.

Painter's naphtha can be used to remove excess adhesives and/or wet oil-base paint.

AFTERCARE and CLEANING

! WARNING: Cleaning products with labels that say "not suitable for use with ABS, acrylic or polystyrene" **SHOULD NOT BE USED.** Read all labels carefully.

- Excessively hot water may cause surface damage.
- **HARSH CHEMICALS SHOULD NEVER BE USED ON SHOWER WALL SURFACE.** Clean after use with a mild liquid household detergent cleaner. Do not use Lestoil, Lysol Disinfectant (spray or concentrate), or Lysol Basin, Tub and Tile Cleaner, Windex, Mr. Clean, Dow Disinfectant Bathroom Cleaner, or cleaning products in aerosol cans.
- Do not use wire brushes, knives or sharp objects to remove stains, cigarette tar deposits, or other surface blemishes.
- Abrasive cleaners or powders must not be used, since they will dull the surface. If the glossy surface loses its sheen, dulled areas or light scratches can be restored by rubbing with a white "automotive type" polishing compound and waxing with a "liquid wax."
- **Do not wax areas where you walk or stand.**
- Do not allow nail polish remover, acetone, dry cleaning fluid, paint remover or other solvents to come into contact with the surface.
- Clean the surrounding surface immediately after using caustic drain cleaners.
- Burning cigarettes will damage the surface.
- Should damage to the fixture occur, repairs can be made quickly and easily.
Your distributor or builder can provide details.

AS America, Inc. 10 Year Limited Warranty for COLONY Bath Walls

AS America, Inc. ("American Standard") warrants to the original consumer purchaser that it will, at its option, repair or replace the walls or any of its parts that are found by American Standard, in its sole judgment, to be defective under normal residential use and maintenance so long as it is owned by the original consumer purchaser.

To activate this limited warranty, the purchaser must go online to our website at www.americanstandard-us.com/warranty to register their bath walls within thirty (30) days of purchase.

In no event will American Standard be liable for the cost of repair or replacement of any materials damaged during installation including but not limited to tiles and marble.

This limited warranty DOES NOT COVER the following:

1. Defects or damages arising from shipping, installation, alterations, accidents, abuse, misuse, lack of proper maintenance and cleaning as directed in the owner's manual and use of other than genuine American Standard replacement parts, in all cases whether caused by a plumbing contractor, service company, the owner or any other person.
2. Deterioration through normal wear and tear and the expense of normal maintenance.
3. Commercial application.
4. Options and accessories. American Standard's limited warranty on these items is one year for parts only and excludes labor. This one year limited warranty covers accessories manufactured by American Standard (e.g. aprons, drains, grab bars, heaters, trim kits) against defects of material or workmanship. Warranty coverage begins on the date the accessory was originally purchased by the owner.
5. Postage or shipping costs for returning products for repairs or replacement under this limited warranty and labor or other costs incurred in connection with product removal or installation under this limited warranty.
6. ANY LIABILITY FOR CONSEQUENTIAL OR INCIDENTAL DAMAGES, ALL OF WHICH ARE HEREBY EXPRESSLY DISCLAIMED, OR THE EXTENSION BEYOND THE DURATION OF THIS LIMITED WARRANTY OF ANY IMPLIED WARRANTIES, INCLUDING THOSE OF MERCHANTABILITY OR FITNESS FOR AN INTENDED PURPOSE. (Some jurisdictions do not allow limitations on how long an implied warranty lasts, or the exclusion or limitation of incidental or consequential damages, so these limitations and exclusions may not apply to you.)
7. Responsibility for compliance with local code requirements. (Since local code requirements vary greatly distributors, retailers, dealers, installation contractors and users of plumbing products should determine whether there are any code restrictions on the installation or use of a specific product.)

This warranty gives you specific legal rights. You may have other legal rights that vary from state to state. For service under this warranty, you should contact the following:

In the United States:

American Standard Brands
1 Centennial Ave.
Piscataway, New Jersey 08854
Attention: Director of Consumer Affairs

For residents of the United States, warranty information may also be obtained by calling the following toll free number: (800) 442-1902
www.americanstandard.com

In Canada:

AS Canada ULC
5900 Avebury Rd.
Mississauga, Ontario
Canada L5R 3M3

Toll Free: (800) 387-0369
www.americanstandard.ca

In Mexico:

American Standard B&K Mexico
S. de R.L. de C.V.
Via Morelos #330
Col. Santa Clara
Ecatepec 55540 Edo. Mexico
Toll Free: 01-800-839-1200
www.americanstandard.com.mx